

ANDERSON LAKE

Location: Sec. 20 & 21, T.148N. R.30W.
Scale: 8 Inches = 1 Mile

BELTRAMI COUNTY

Chippewa National Forest
Minnesota

4-19

Area 78.5 Acres
Length of Shoreline 1.50 Miles

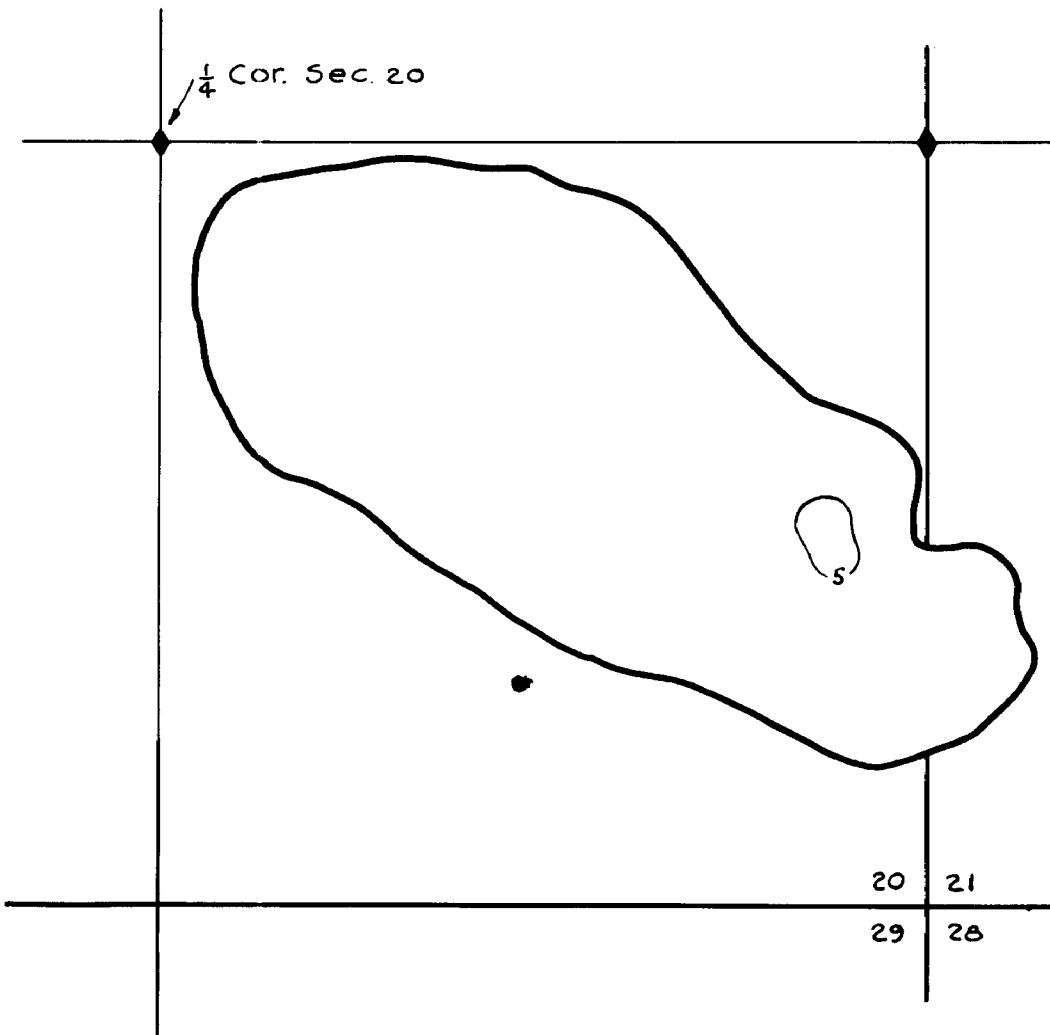

Contour Map
Contour Interval = 5'

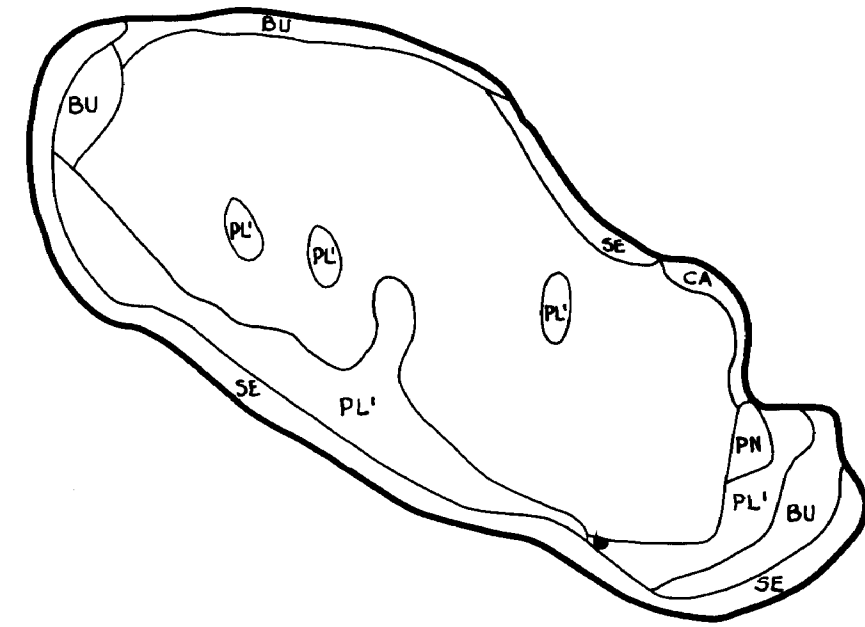

Aquatic Vegetation Map

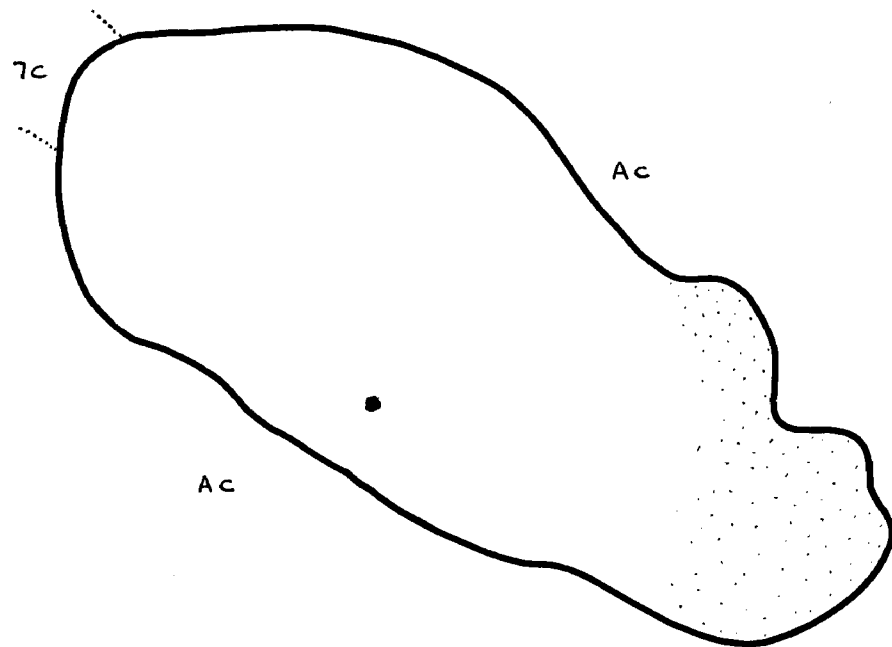

Cover Type And
Lake Bottom Soil Type Map

STATE OF MINNESOTA
Department of
Administration



Minnesota's Bookstore
Part of the Department of Administration
Print Communications Division
To order reproduced copies of
Contour Lake Maps call:
612/297-3000 or our
Nationwide toll-free number
1-800-657-3757

© COPYRIGHT 1993
STATE OF MINNESOTA
DEPARTMENT OF NATURAL RESOURCES
DIVISION OF FISH AND WILDLIFE

© State of Minnesota 1964

© State of Minnesota